

Thanks for choosing Bernkot stainless steel shower niche. If you have any problems, please send messages to us ([support@bernkot.com](mailto:support@bernkot.com)). Prior to install please check wall niche received, protect all surfaces from sharp objects and chemical hazards. The information provided in this instruction are general guidelines. Consult local building codes to ensure the installation complies with standards in your area. The warranty will be void if the products is installed with a conspicuous defect.

### Preparation & Placement

The following tools and materials maybe needed: Stud finder, Saw & Utility knife, Level, Ruler or Tape measure, Pencil, Notched trowel, Silicone sealant, Waterproof membrane. The substrate surface should be smooth, level, clean and free of all dirt, oil, paint, concrete sealers or curing compounds.

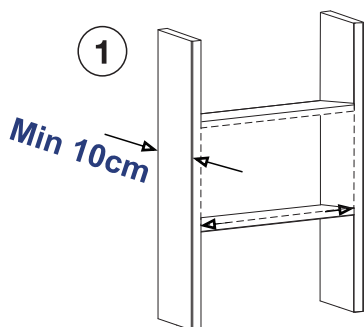

1. Bernkot shower niche are designed to 10cm depth. Please note the wall stud thickness should not less than 10cm, the space between adjacent studs should not less than "niche width". Otherwise probably unavailable for installation.

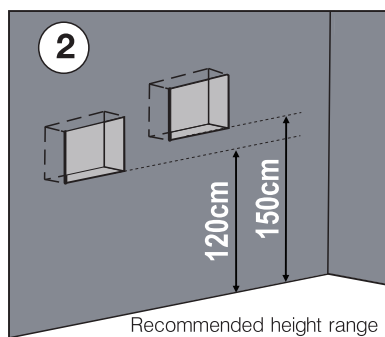

2. The ideal height for a wall niche sits at chest to eye level when standing -- a height of around 120cm to 150cm that suits most adults. If have kids at home, considering lower height to ensure safety.

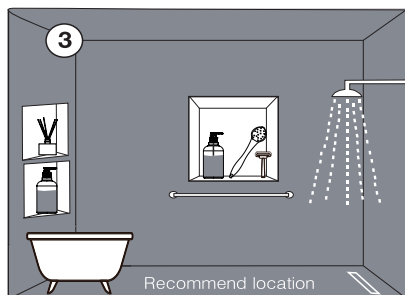

3. Install a niche on an opposite or adjacent wall to the shower head, so you can access items without reaching through the shower spray. If you need to access the niche while in the bathtub, consider a second niche lower down, or add height to the niche for access when taking a shower or bath.

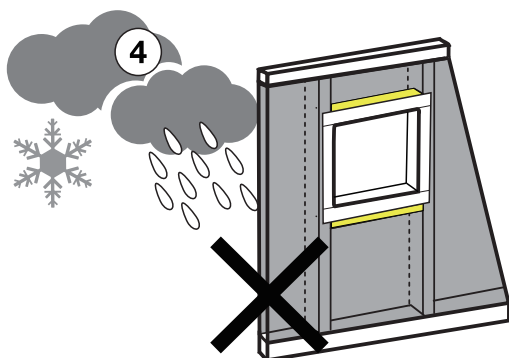

4. Niches should not be against outside walls if possible in cold weather climates. The niche space will replace valuable insulation. If you must use an outside wall, be sure to put in some form of polyurethane insulation or the tile may frost up on cold winter days.

5. Keep the dimensions in mind when specifying a niche. It is best for tile to be symmetric around a niche. The tile line can end right on the niche for a very clean look.

6. Make sure your contractor waterproof the niche with a product like Red Guard and ensure properly watertight along the edge. This is particularly important with mosaic tiles. A leak from a niche will cause substantial damage over time.

## Installation Steps

The following installation details are applicable for existing wall before tiling, do not cover every possible situation. Always consult with licenced professional during preparation and installation.

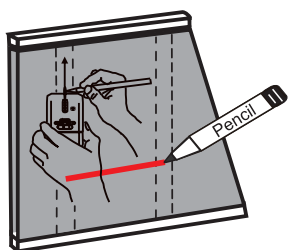

1. Locate and mark the center lines of adjacent framing studs using a stud finder or by tapping the wall. Draw level line between the two wall studs at your desired height of niche.

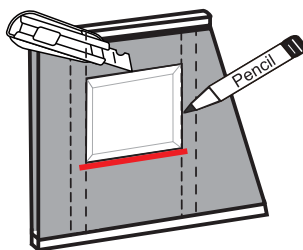

2. Trace the cutline with pencil, above the center line, cut out a cave on the wall board along the traced line. Be sure the top and bottom lines are level.

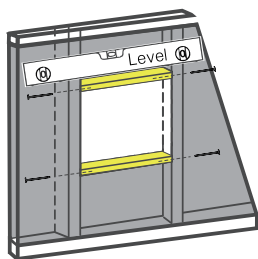

3. Level and fasten the top and bottom support framing to adjacent vertical studs, make the vertical dimensions matches the niche flange. Please leave the thickness of waterproof membrane.

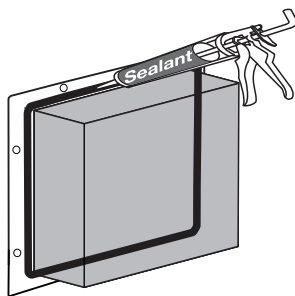

4. Apply a uninterrupted thin bead of polyurethane sealant around the perimeter of the flange. Do not cover the predrilled holes. This creates the initial seal between the backboard and the fixture.

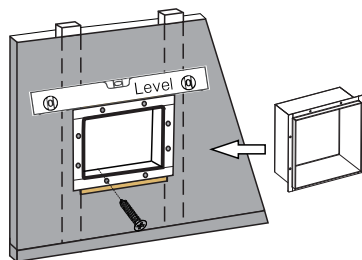

5. Insert the niche fixture into the framing. Ensure the niche plumb and level. Fasten the flange to the backboard using stainless steel screw in each pre-drilled hole. Be careful not to over tighten the screws.

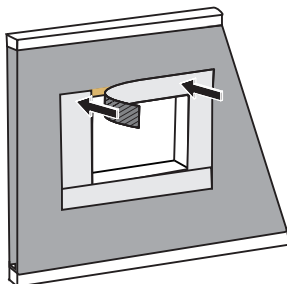

6. Apply the waterproofing membrane on the flange, carefully press the membrane against the flange to spread the sealant and to eliminate any high points.

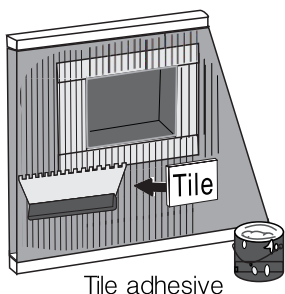

7. Apply your setting material and set your tile, marble or stone directly to shower wall. Evenly fill the gaps between the tile and niche with grout or silicon.

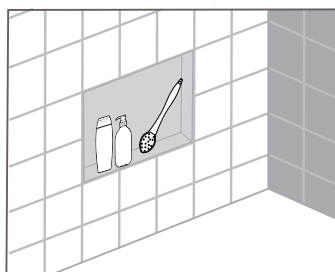

8. It is best for tile to be symmetric around a niche. The tile line can end right on the niche for a very clean look. Waiting 24 hours before using your shower or follow the instruction of the setting material.

Note:

1. If for newly constructed wall, start installation from step 3.
2. If the distance between vertical studs greater than the niche, attach vertical framing to one or both vertical studs to accommodate the niche.
3. Building codes now prohibit the use of water-resistant gypsum wallboard ("green board") as the tile backer in showers.



## Care & Maintenance

After installation, some aggressive substance such as sealant, adhesive, mortar maybe cause "yellow spot" on the brushed surface, recommend using scour pad to remove such "spot", and always brushing in the direction of the grain.

- Periodically clean the fixture with mild liquid dish detergent and clean rag. If there is any soap scum left after rinsing, use a sponge or micro-fibre rag to carefully remove the material.
- To reduce the chance of scratching, take care to wipe in the direction of the grain (direction of striations).
- Do not use abrasive cleaners, rubbing alcohol, detergents, chlorine bleach based cleaners, aggressive chemicals, abrasive cleaning pad, or harsh polishes on the fixture. Use of such substance may void the warranty.
- If you are using a chlorine bleach containing cleaner in your shower, make sure that you avoid the niche surface and promptly remove any residue that may end up on the niche surface.



**\*Scour Pad**

Only be allowed to remove stain on brushed finish.